

# WARING COMMERCIAL

Xtreme Blenders with Paddle Switch  
64 oz. Stackable Container

## MX1000XTX

## MX1000XTXGR

Grainger

## SUP1000XTX

Superior - US Foods (last built 11/4/2014)

### Unit Information

Limited 3 Year Motor Warranty  
Two Year Parts & Labor

60Hz - 13 Amps - 1560 Watts  
Height 19" - Weight 15 lbs.

3 HP Motor  
30,000+ RPM's

One Piece Dishwasher Safe  
Removable Jar Pad

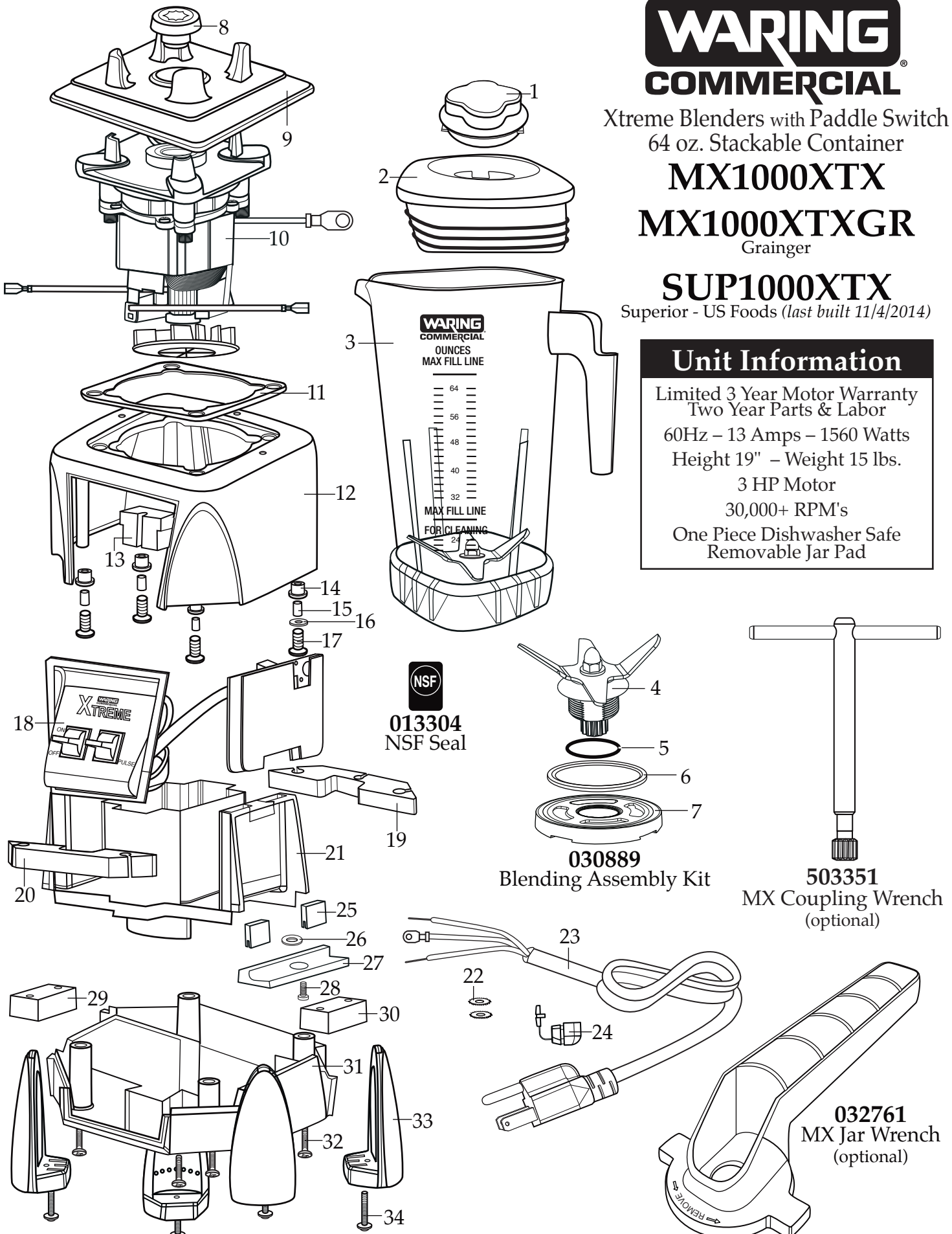

**Catalog**

**Model**

MX1000XTX  
 MX1000XTXGR  
 SUP1000XTX

MX1000XT41



Illustration#	Part#	Description
1	026425-E	Jar Lid Cover
2	026424-V	Vinyl Jar Lid <i>(changed after 12/5/2012)</i>
3	503326	64 oz. Stackable Container <b>ONLY</b>
	503398	64 oz. Stackable Container with Blending Assembly <i>(on units after 2/4/2011)</i>
	503350	64 oz. Stackable Container with Blending Assembly
4	503397	Blade Assembly <i>(changed after 2/4/2011)</i>
5	024271	Bearing Holder O Ring
6	024268	Nut Gasket
7	029631	Bearing Holder Nut
8	028538	Drive Coupling
9	026442	Jar Pad
10	035396	Leili without Sensor <i>(on units after 8/3/2017)</i>
	028100	ECM Motor without Sensor
11	026437	Dampening Plate Gasket
12	028032-09	Black Top Housing
13	028541	Motor Foam (2 required)
14	026439	Dampening Plate Bushing (4 required)
15	026453	Dampening Plate Sleeve (4 required)
16	026459	Stainless Steel Washer
17	028929	Sems (4 required)
18	036394	Control Panel with Interlock <i>(on units after 2/8/2019)</i>
	033465	Soft Start Sealed Switch Control Panel <i>(changed after 6/13/2013 use 036394)</i>
	029808	Soft Start Control Panel <i>(on units after 3/2/2011 use 033465)</i>
	028388	Control Panel (use 029808)
19	028248	Top Housing Foam Rear Baffle
20	028249	Top Housing Foam Front Baffle
21	036814	Motor Housing 2.78" <i>(on units after 7/18/2019)</i>
	028240-67	Motor Housing <i>(on units after 8/3/2017)</i>
	028240	Motor Housing
22	002943	Washer (2 required)
23	026925	Cord Set
24	007556	Strain Relief

Illustration #	Part #	Description
25	034900	PCB Cushions (2 required <i>on units 7/18/2019</i> )
26	037232	Neoprene Washer ( <i>on units after 7/18/2019</i> )
27	037007	PCB Mounting Bracket ( <i>on units after 7/18/2019</i> )
28	013768	Screw ( <i>on units after 7/18/2019</i> )
29	028247	Bottom Housing Foam Baffle
30	028542	Foam Baffle
31	028241-09-X	Black Bottom Housing
32	012505	Screw (4 required)
33	026430	Corner Post (4 required)
34	028928	Sems (4 required)

  
**033483**  
 Brush/Spring  
 (2 required use with ECM motor)

